



3-IN-1 FAMILY SCALE

Instruction Manual



Please read the user's manual and warnings before using the device for the first time. Pay special attention to safety tips to avoid accidents and/or damage to the product when using it. Keep the user's manual for reference purposes

The electronic scale is a versatile device designed to help you keep track of your weight at home. It can be used by people of all ages, including infants, toddlers, and adults, making it an essential tool for families.

I. Device Instruction

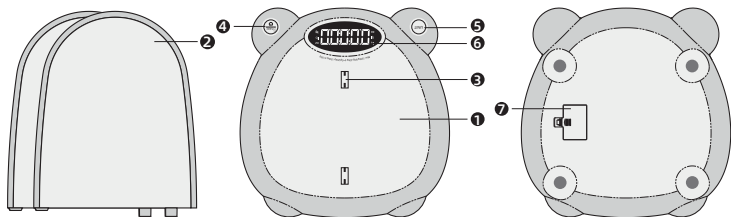

① Weighing Scale

- To accurately measure weight.

② Detachable Trays

- The scale comes with two detachable trays that can be assembled together to create a full tray. This makes it ideal for weighing babies and young children.

③ Assembly Groove

- There is a groove on the scale to securely hold the trays in place during weighing.

④ ON/OFF/TARE button

- A. Press the button to switch on/off scale;
- B. Press the button "TARE", if you put a towel on the scale before put baby on it, its display goes back to "0.00" to include the towel weight.

⑤ Unit Button has two functions:

- A. Press the button to switch between units of measurement: lb, oz, or kg.
- B. Long press the button for 2-3 seconds to change the display direction.

⑥ Display (LED)

- Size: 3.55x1.03in

⑦ Battery Installation

- insert 3xAAA battery.

II. Device Operation

1. Weighting in Baby Mode

- 1) Place the scale on a hard and flat surface. Do not use it on carpet or any soft surface as it may affect accuracy.
- 2) Insert the batteries and attach the baby weighing tray to the assembly groove. Press it down to secure it in place.
- 3) Press the "ON/OFF" button to turn on the scale.
- 4) Wait for the display to show "0.00lb", then long press the "UNIT" button to adjust the display direction to match the reader's side.
- 5) Place the baby on the trays safely and wait for the scale to stabilize.

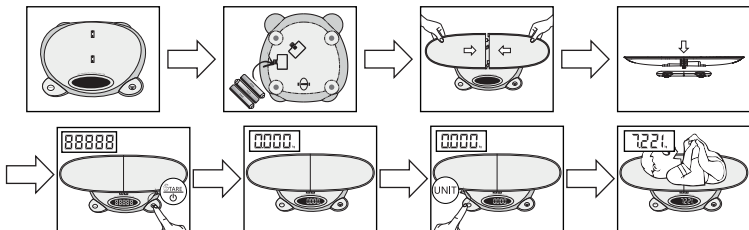

◆ Auto Lock function

Do not move the baby off the tray while the scale is in use. The data will automatically lock after three flickers.

◆ Reset and Tare Function:

- A. Press the "TARE" button if you need to put a towel or cloth on the tray before weighing the baby. This will reset the display to "0.00".

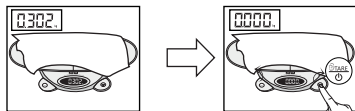

- B. Press the "TARE" button if the data is locked and you need to weigh another baby. This will reset the display to "0.00", allowing you to weigh the new baby without interference from the previous data. This function can be repeated as needed.

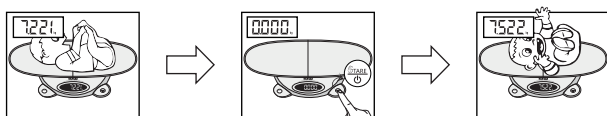

◆ Unit Conversion

Press "UNIT" button to convert "lb" "oz" and "kg".

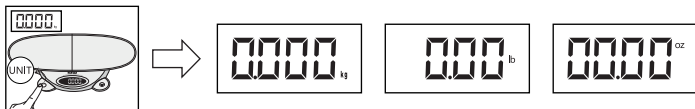

◆ Overload Indication

If the weight is over loaded "max capacity", LED display shows "Err".



◆ Low Power Indication

When LCD display shows "Lo", Please replace the new battery with correct polarity.



◆ Auto Off without any operation after 60 seconds.

2. Weighting in Mother Mode

- 1) Place the scale on a hard and flat surface. Do not use it on carpet or any soft surface as it may affect accuracy.
- 2) Remove the trays from the groove by pulling them up as illustrated in the user manual.
- 3) press the "ON/OFF" button to turn on the scale.
- 4) Wait for the display to show "000lb", then long press the "UNIT" button to adjust the display direction to match the reader's side.
- 5) Stand on the scale surface to measure your weight. Ensure that you stand still and evenly distribute your weight on both feet for accurate readings.

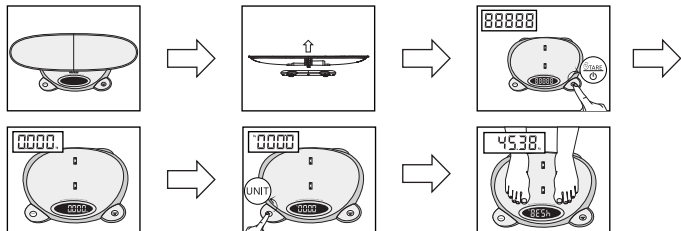

III. Product Specification

- 1) Size: 25.6x12.6x3.5in
- 2) Material : Full ABS plastic.
- 3) Capacity: 40lb for baby weighting mode; Max. 265lb for adult mode.
- 4) Graduation: D=0.01oz (Weight in 2oz~40lb); D=0.1oz (weight in 40lb~265lb).
- 5) Unit: lb, oz, kg.
- 6) Touch ON/OFF.
- 7) 4 high precision strain gauge sensor.
- 8) Tare function.
- 9) Auto lock/hold function (easier weighing of moving babies-the result is automatically locked weight).
- 10) Low battery and over load indicate.
- 11) LED display size: 3.55x1.03in.
- 12) Touch switch display direction.
- 13) Power: 3x1.5V AAA battery

IV. Safety Precautions

- The scale should be placed on a flat, dry, and hard surface during use to ensure accurate measurements.
- Use this device for its intended purpose at home only.
- Do not exceed the scale's maximum capacity of 265lb. Overloading the scale may cause damage and inaccurate readings.
- Avoid shaking or hitting the scale as it may affect its accuracy.
- Do not submerge in water.
- When in storage, do not place anything on the scales.
- The optimal temperature for operating and storing the scales is 41°F~104°F.
- The scale is meant for household purposes and is not intended to be used for commercial and medical purposes.

Note: The scale is designed for personal use only and should not be used to diagnose or treat any medical conditions. If you have any concerns about your health, please consult a qualified healthcare professional.

THIS DEVICE IS ONLY HOUSEHOLD USE,

NO MEDICAL OR COMMERCIAL USE.

THANKS!

Warranty Card

If you want to claim warranty service, please fill out the warranty card below and return it with the product.

Customer's Name: _____

Email: _____

Phone: _____

Address: _____

Dealer's name: _____

Dealer's address: _____

Date of purchase(DD/MM/YY): _____

Order number: _____

Serial Number: _____

Type of services: ☐ Repair ☐ Exchange ☐ Return

Description of issues: _____

The serial number can usually be found on the bottom of the product.



Ellie Technology, LLC

www.elliehello.com

Made in China